

## Hammond Hand Held Instrument Boxes – 1593

Designed as electronic instrument enclosure with provision for mounting PCBs.

- Protection against dust and splashes.
- Comfortable fit in the users hand.
- Box and PCB secured with self tapping screws.
- Optional Infrared panel and Belt or Pocket clip.
- Material: General purpose ABS in Black or Grey.
- 1593NBK and GY are specifically designed for smart card readers.
- Prototype PC Board available.

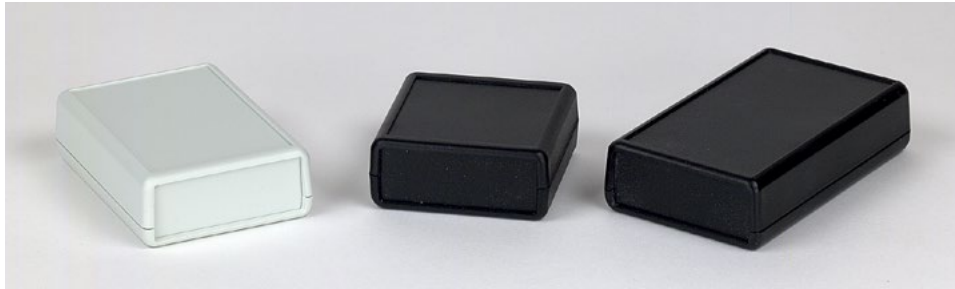

**Version A**

**Version B**

**Version C**

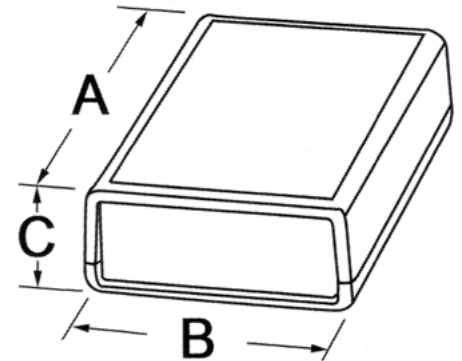
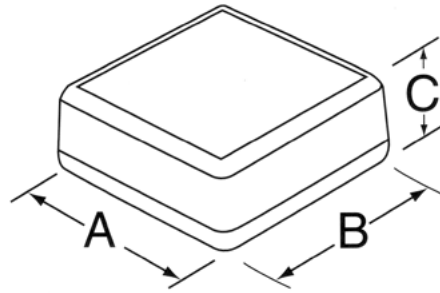
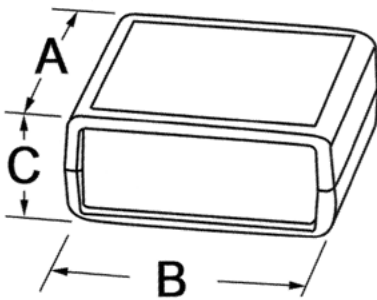

For detailed drawings and CAD files visit [www.hammondmfg.com](http://www.hammondmfg.com).

Part Number Black	Part Number Grey	Part Number Translucent Blue	Length A	Width B	Height C	Version	Battery Door	Removable Panels
26-1593KBK	26-1593KGY	26-1593KTBU	66	66	28	A	No	2
26-1593JBK	26-1593JGY	26-1593JTBU	66	66	28	B	No	0
26-1593SBK	26-1593SGY	26-1593STBU	92	66	21	C	Yes*	1
26-1593LBK	26-1593LGY	26-1593LTBU	92	66	28	A	No	2
26-1593NBK	26-1593NGY	26-1593NTBU	110	75	25	A	No	2
26-1593PBK	26-1593PGY	26-1593PTBU	92	66	28	C	Yes	1
26-1593TBK	26-1593TGY	26-1593TTBU	112	66	21	C	Yes*	1
26-1593QBK	26-1593QGY	26-1593QTBU	112	66	28	C	Yes	1
26-1593DBK	26-1593DGY	26-1593DTBU	114	36	25	A	No	2
26-1593YBK	26-1593YGY	26-1593YTBU	140	66	28	C	Yes	1
26-1593XBK	26-1593XGY	26-1593XTBU	140	66	28	A	No	2

\* AAA batteries are the largest size Models 1593S & 1593T will accept due to its low profile.